

**EXPLORER cave**

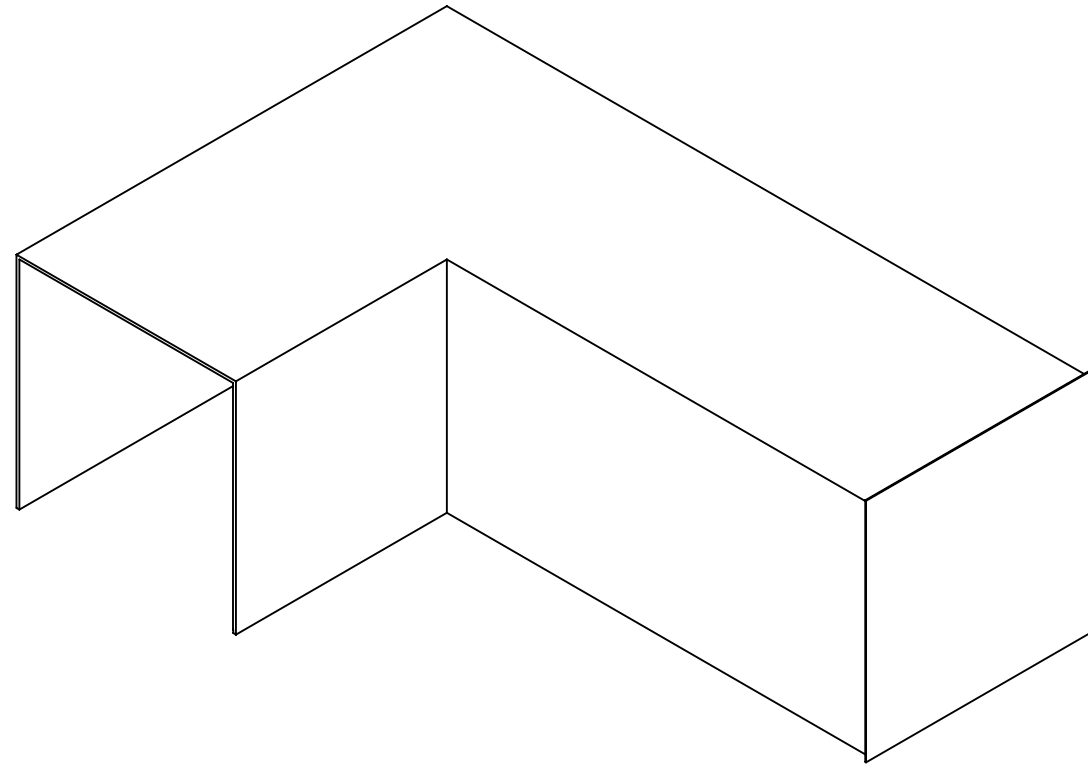

**RANGER cave front view**

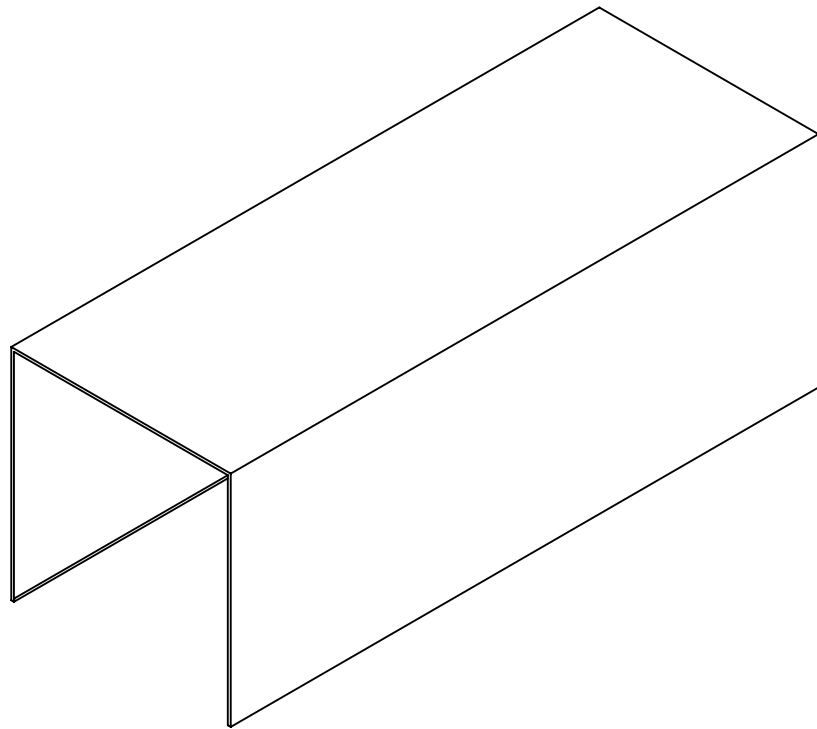

**RANGER cave back view**

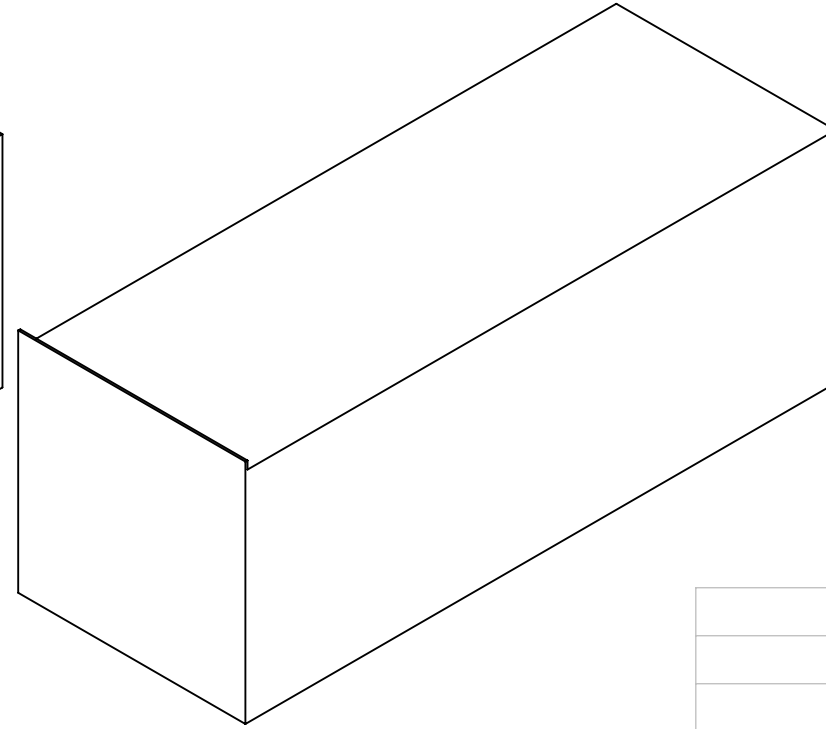

**Task #2: Collect samples of a new species of crustacean**

**Crustacean:**

The crustacean is a Kalin's 6-inch Mogambo grub fishing lure.

All crustaceans are found within the last 0.5 meters of the cave.

Each cave will contain ten crustaceans.

**Caves:**

The cave is constructed out of a 1/2-inch PVC framework covered by either black plastic or a tarp. The back cave wall is created from an 85cm by 85cm hard black plastic sheet.

The opening and inside diameter of the cave are 80cm by 80cm.

**EXPLORER cave:**

The EXPLORER cave is 3 meters to 3.5 meters long, with a 90 degree turn 1-2m from the opening.

**RANGER cave:**

The RANGER cave is 2 meters to 2.5 meters long and straight.

**PROPRIETARY AND CONFIDENTIAL**  
 THE INFORMATION CONTAINED IN THIS DRAWING IS THE SOLE PROPERTY OF THE MATE CENTER. ANY REPRODUCTION IN PART OR AS A WHOLE WITHOUT THE WRITTEN PERMISSION OF THE MATE CENTER IS PROHIBITED.

		UNLESS OTHERWISE SPECIFIED:		NAME	DATE	MATE Center		
		DIMENSIONS ARE IN CM TOLERANCES: FRACTIONAL ± ANGULAR: MACH ± BEND ± TWO PLACE DECIMAL ± THREE PLACE DECIMAL ±		DRAWN				TITLE: <b>EXPLORER and RANGER class caves</b>
		INTERPRET GEOMETRIC TOLERANCING PER:		CHECKED		SIZE <b>B</b>	DWG. NO.	
		MATERIAL		ENG APPR.		SCALE: 1:20 WEIGHT: SHEET 1 OF 1		
		FINISH		MFG APPR.				
NEXT ASSY	USED ON			Q.A.				
APPLICATION		DO NOT SCALE DRAWING		COMMENTS:				